

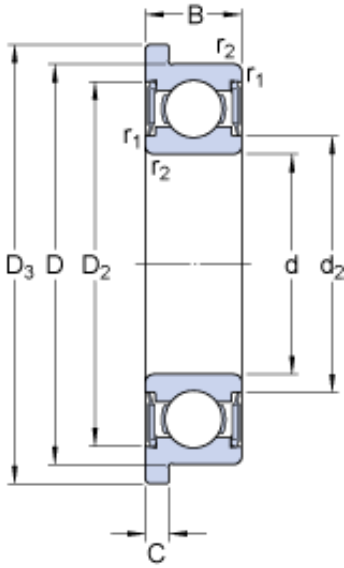

NTN bearing de Mexico, S.A.

3 mm x 10 mm x 4 mm skf W 623 R-2RS1 Deep groove ball bearings

Bearing No. W 623 R-2RS1



W 623 R-2RS1 Bearing 2D drawings and 3D CAD models

Size	10x3x4 mm
Bore Diameter	10 mm
Outer Diameter	3 mm
Width	4 mm
d	3 mm
D	10 mm
B	4 mm
d ₂	4.35 mm
D ₂	7.98 mm
D ₃	11.5 mm
C	1 mm
r _{1,2} - min.	0.15 mm
d _a - min.	4.4 mm
r _a - max.	0.15 mm
Basic dynamic load rating - C	0.358 kN
Basic static load rating - C ₀	0.11 kN
Fatigue load limit - P _u	0.005 kN
Limiting speed	40000 r/min
Calculation factor - k _r	0.03
Calculation factor - f ₀	6.3
d ₂	4.35 mm
D ₂	7.98 mm
D ₃	11.5 mm
r _{1,2} min.	0.15 mm



NTN bearing de Mexico, S.A.

d_a min.	3.9 mm
d_a max.	4.3 mm
r_a max.	0.15 mm
Basic dynamic load rating C	0.358 kN
Basic static load rating C_0	0.11 kN
Fatigue load limit P_u	0.005 kN
Calculation factor k_r	0.03
Calculation factor f_0	6.3
Mass bearing	0.0017 kg