

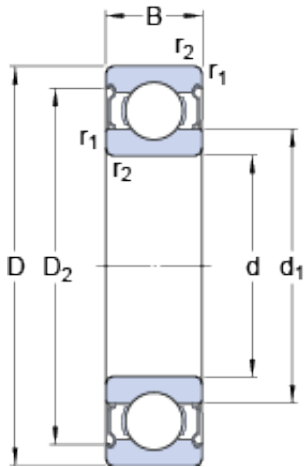

## NTN bearing de Mexico, S.A.



100 mm x 150 mm x 24 mm skf 6020-2Z Deep groove ball bearings

Bearing No. 6020-2Z

6020-2Z Bearing 2D drawings and 3D CAD models

|   |                          |
|---|--------------------------|
| Size                                      | 150x100x24 mm            |
| Bore Diameter                             | 150 mm                   |
| Outer Diameter                            | 100 mm                   |
| Width                                     | 24 mm                    |
| d   | 100 mm                   |
| D   | 150 mm                   |
| B   | 24 mm                    |
| d <sub>1</sub>                            | 115,95 mm                |
| D <sub>2</sub>                            | 138,3 mm                 |
| r <sub>1,2</sub> - min.                   | 1,5 mm                   |
| d <sub>a</sub> - min.                     | 107 mm                   |
| d <sub>a</sub> - max.                     | 115,9 mm                 |
| D <sub>a</sub> - max.                     | 143 mm                   |
| r <sub>a</sub> - max.                     | 1,5 mm                   |
| Basic dynamic load rating - C             | 63,7 kN                  |
| Basic static load rating - C <sub>0</sub> | 54 kN                    |
| Fatigue load limit - P <sub>u</sub>       | 2 kN                     |
| Reference speed                           | 9500 r/min               |
| Limiting speed                            | 4500 r/min               |
| Calculation factor - k <sub>r</sub>       | 0,025                    |
| Calculation factor - f <sub>0</sub>       | 15,9                     |
| Category                                  | Single Row Ball Bearings |
| Inventory                                 | 0.0                      |
| Manufacturer Name                         | SKF                      |



## NTN bearing de Mexico, S.A.

|                                 |   |
|---------------------------------|---|
| Minimum Buy Quantity            | N/A   |
| Weight / Kilogram               | 1.34  |
| Product Group                   | B00308  |
| Enclosure                       | 2 Metal Shields   |
| Precision Class                 | ABEC 1   ISO P0   |
| Maximum Capacity / Filling Slot | No  |
| Rolling Element                 | Ball Bearing  |
| Snap Ring                       | No  |
| Internal Special Features       | No  |
| Cage Material                   | Steel   |
| Internal Clearance              | C0-Medium   |
| Inch - Metric                   | Metric  |
| Long Description                | 100MM Bore; 150MM Outside Diameter; 24MM Outer Race Diameter; 2 Metal Shields; Ball Bearing; ABEC 1   ISO P0; No Filling Slot; No Snap Ring; No Internal Special Features |
| Category                        | Single Row Ball Bearing   |
| UNSPSC                          | 31171504  |
| Harmonized Tariff Code          | 8482.10.50.68   |
| Noun                            | Bearing   |
| Keyword String                  | Ball  |
| Manufacturer URL                | <a href="http://www.skf.com">http://www.skf.com</a>   |
| Manufacturer Item Number        | 6020-2Z   |
| Weight / LBS                    | 2.95  |
| Outer Race Width                | 0.945 Inch   24 Millimeter  |
| Outside Diameter                | 5.906 Inch   150 Millimeter   |
| Bore                            | 3.937 Inch   100 Millimeter   |
| bore diameter:                  | 100 mm  |
| static load capacity:           | 54 kN   |
| outside diameter:               | 150 mm  |
|                                 |   |



## NTN bearing de Mexico, S.A.

|                                |                          |
|--------------------------------|--------------------------|
| precision rating:              | Not Rated                |
| overall width:                 | 24 mm                    |
| finish/coating:                | Uncoated                 |
| bore type:                     | Round                    |
| cage material:                 | Steel                    |
| closure type:                  | Double Shielded          |
| outer ring width:              | 24 mm                    |
| row type & fill slot:          | Single Row Non-Fill Slot |
| fillet radius:                 | 1.5 mm                   |
| internal clearance:            | C0                       |
| maximum rpm:                   | 4500 RPM                 |
| dynamic load capacity:         | 63.7 kN                  |
| series:                        | 60                       |
| $d_1$                          | 115.95 mm                |
| $D_2$                          | 138.3 mm                 |
| $r_{1,2}$ min.                 | 1.5 mm                   |
| $d_a$ min.                     | 107 mm                   |
| $d_a$ max.                     | 115.9 mm                 |
| $D_a$ max.                     | 143 mm                   |
| $r_a$ max.                     | 1.5 mm                   |
| Basic dynamic load rating C    | 63.7 kN                  |
| Basic static load rating $C_0$ | 54 kN                    |
| Fatigue load limit $P_u$       | 2.04 kN                  |
| Calculation factor $k_r$       | 0.025                    |
| Calculation factor $f_0$       | 15.9                     |
| Mass bearing                   | 1.32 kg                  |